



Whats App



Email

# Action camera User Manual

## Q60

Made in China



# MAINTENANCE

## ■ Underwater Usage Notes

This camera are splash, water, and dust resistant and were tested under controlled laboratory conditions with a rating of IP68 under IEC standard 60529 (maximum depth of 20 meters up to 30 minutes). Splash, water, and dust resistance are not permanent conditions and resistance might decrease as a result of normal wear.

## ■ The waterproof conditions for IP68 :

- Clear water at normal temperature, tested at a depth of 20 meters.
- The testing time is 30 minutes.
- The temperature difference between the water temperature and the product shall not exceed 5 degrees Celsius.

In order to ensure the waterproof performance of the camera, please carefully refer to the operation and maintenance precautions as following. The camera is not waterproof due to improper operation and improper maintenance, which is not covered by the warranty.

1. Make sure to check whether the silicone pads on the waterproof cover is clean before using underwater. Otherwise it will affect the camera's waterproof ability, and a single hair or sand will cause leakage!
2. Make sure to check whether the silicone pad on the battery waterproof cover is intact, Damage to the silicone pad will cause water leakage!
3. Make sure that the battery waterproof cover is tightly closed before using underwater. If not, the camera will not be waterproof.
4. Avoid jumping into water a high speed with camera. Otherwise, the impact may result in water water leakage.
5. DO NOT use the camera in a hot spring or expose the product directly to high temperatures over 40°C. High temperature may cause deformation of the waterproof seal on the camera body and lose its waterproof function.
6. Keep it safe from falling and dropping. Falling and drop will cause damage to the watertight seal on the camera body and the camera is not waterproof.
7. The microphone and speaker's hole on the camera has built in waterproof material. DO NOT remove the waterproof material or poke the holes. Otherwise, the camera will no longer be waterproof.
8. Due to the presence of a large amount of microorganisms and salts in seawater, it is important to clean the camera with clean water after use to prevent seawater microorganisms from adhering to the camera surface or metal parts for a long time,

which can cause the camera to decay, rust, etc., and cause the camera's waterproof function to fail.

9. Clean the camera with clean water after using underwater. Allow it to dry naturally before using again.
10. This camera is not waterproof unless the battery cover are closed tightly.

## CAUTIONS

- This is a Ultra HD action camera, It is normal for the housing to exert heat under use.
- Don' t expose the product directly to high temperatures over 45°C.
- Please properly protect well the lens and screen of camera after using.
- Keep it safe from falling and dropping.
- Keep it distance from any strong magnetic interference objects like electrical machine to avoid strong radio waves that might be damaging the product and affect the sound or image quality.
- In case of overheating, unwanted smoke from the device, unplug it immediately from the power outlet to prevent hazardous fire.
- Stored the device in a cool, dry and dust free location.
- Do not modify the camera it in any way,if the camera has been detached,the warranty will be void.

## OVERVIEW OF CAMERA

The camera is an all-weather action camera, equipped with 6-axis gyroscope EIS technology, which can take UHD photos and videos. This camera adopting watertight seal and a hydrophobic coating on the camera body, which can reach IP68 waterproof level. This action camera is weatherproof and distinct to unlock all the filming scenarios and ease your vlogging experience. Its IPX8 water-resistant design can protect the action camera from rain, snow and water splashing.



- |                                   |                             |
|-----------------------------------|-----------------------------|
| 1. Lens                           | 6. Battery Waterproof Cover |
| 2. Speaker                        | 7. Indicator                |
| 3. Internal Microphone            | 8. Power Button             |
| 4. Shutter Button / Select Button | Screen-switching Button     |
| 5. Front Screen (Non-touch)       | 9. Touch Screen             |

## ■ **Button Operation Instructions**

### ● **Power Button Button:**

1. In the Power off state, press shortly to turn on the camera;
2. In the power on state, press and hold for 3 seconds to turn off the camera;
3. In video or photo mode, press shortly to switch between front and rear screen;
4. In playback mode, press shortly to switch between video and photo playback modes;
5. In video or photo playback mode, press shortly to return to the playback menu;
6. In the settings menu, press shortly to switch settings mode;
7. Shortly press to turn off camera WIFI while WIFI is on;
8. In screen saver mode, shortly press to wake up the display screen;

### ● **Shutter Button:**

1. In video mode, short press to start/stop recording;
2. In photo mode, short press to take photos;
3. In playback mode, short press to confirm the selected playback mode;
4. In video playback mode, short press to play/pause the video file;
5. In settings mode, short press to confirm the selected option;
6. In screen saver mode, short press to wake up the display screen

Notes:

- ✧ You can't switch screens during video recording or in Setting Mode.
- ✧ Front and rear screens cannot work at the same time.

## **GETTING STARTED**

Welcome to your new camera. To capture video and photos, you need a micro SD card.

### ■ **Storage / Micro Cards**

We strongly recommend to use the branded memory cards purchased from regular channels for maximum reliability and stability during recording and in high vibration activities.

- **UHS-III rating at least for 4K Video resolution**

(at least 60MB/S or above read and writing speed)

- Capacity up to 128GB (FAT32)

The bigger memory may have an effect on the compatibility with the camera.

Notes:

- ✧ Please format the micro SD on the camera before first using.
- ✧ Please insert the memory card in correct way. if not, the card slot maybe damage by the wrong way.
- ✧ To keep your micro SD card in good condition, reformat it on a regular basis.

## ■ Powering On+ Off

- **To Power On:**

Press shortly the Power button. When information appears on the LCD display, your camera is on.

- **To Power Off:**

Press and hold the Mode button for three seconds. When information disappears on the LCD display, your camera is off.

## OVERVIEW OF MODES

There are 6 modes: Video, Slow Motion, Time Lapse, Photo, Self-Time, and Photo Lapse.

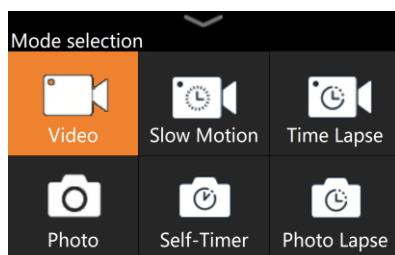

## ■ Mode Selection

- In video/photo mode, tap the "Mode Selection" icon on the screen to enter the mode selection menu. tap the mode icon of any grid to quickly switch to the desired mode.

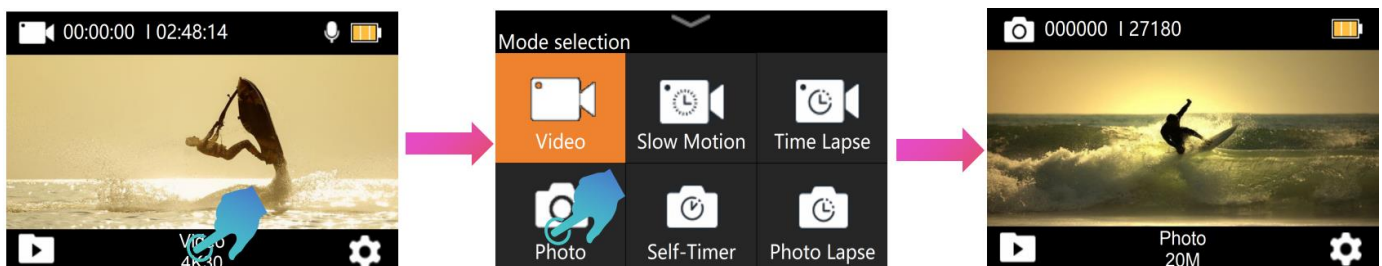

- Exit mode selection menu, click on the "Exit" icon at the top of the screen.



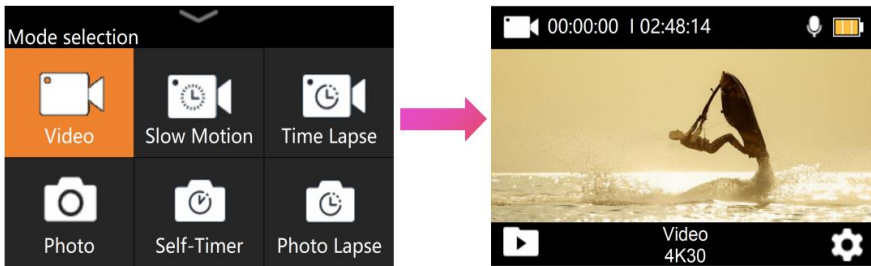

## ■ Three Video Modes: Video, Slow Motion and Time Lapse

### ● Video Mode

Video mode is a regular video recording mode, Video Mode is the default mode when you turn on the camera.

In Video Mode, press Shutter button, the camera start recording video, press Shutter button again to stop recording video.

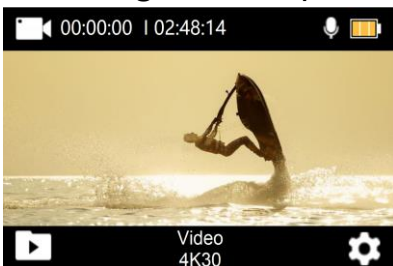

### ● Slow Motion Mode

Slow Motion Video, also known as high-frame-rate video, refers to a technique where the camera records video at a higher frame rate and then plays it back at a lower speed, typically 30 frames per second, resulting in a smoother and more dramatic effect.

In this mode, press the shutter button and the camera will record slow motion video. Audio cannot be recorded in Slow Motion Mode.

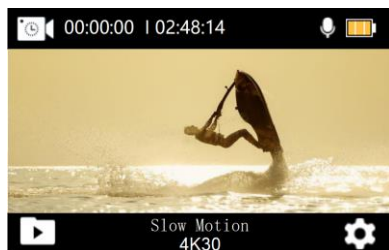

### ● Time Lapse Video Mode

Time Lapse Video creates video from frames captured at specific intervals. This option lets you capture a time lapse event and immediately view or share it as a video.

In Time Lapse Video Mode, press the Shutter button, the camera will take a series of videos at the set interval. Audio cannot be recorded in Time Lapse Video Mode.



## ■ Three Photo Modes: Photo, Self-Time, and Photo Lapse

### ● Photo Mode

Photo mode is single shot mode. In Photo Mode, press Shutter button, the camera takes a photo.



### ● Self-Timer Mode

A self-timer gives a delay between pressing the shutter release and the shutter's firing. It is most commonly used to let photographers to take a photo of themselves.



### ● Photo Lapse

Time Lapse Photo captures a series of photos at specified intervals. Use this mode to capture photos of any activity, then choose the best ones later.



## CUSTOMIZING YOUR CAMERA

There are 3 Setting Modes: Video Setting, Photo Setting and System Setting

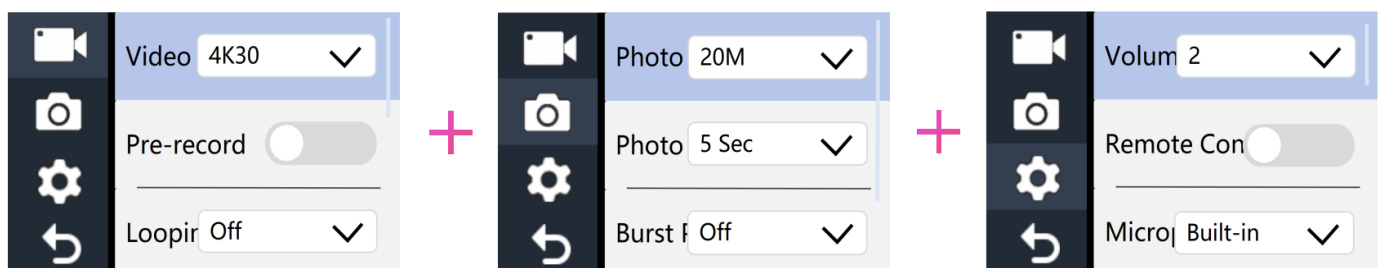

## ■ Video Setting Mode

- 1) Verified in Video Mode, tap the "Settings" icon in the bottom right corner of the screen to enter Video Setting menu.
- 2) Slide up / down quickly in the gray area on the screen to cycle through various options, tag the target option or press the "Shutter Button" to select the desired option to set.
- 3) Tap the "Return" icon in the bottom left corner of the screen or press the "Power Button" to exit.

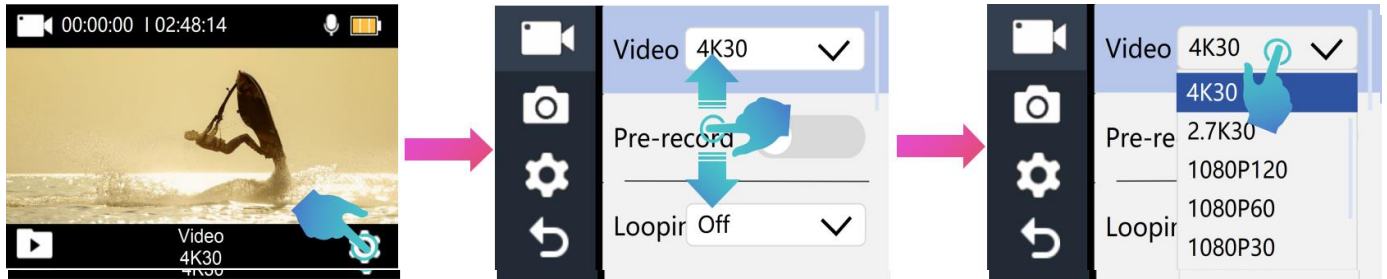

## ❖ Video Settings:

### ● Video Resolution: 4K 60、4K30、1080P120、1080P60、1080P30、EIS 4K30、4K30(9:16)

Default setting is **4K 30fps**.

Notes:

- ✧ This camera is capable of recording 4K30fps or above Video, with higher resolution offering greater clarity and detail due to the increased number of pixels. However, higher resolution video also results in larger file sizes.
- ✧ When capturing video at high resolution or high frame rates such as 4K 60/30fps, the camera may become hot and consume more power, which is normal.
- ✧ Capturing high-resolution or high-fps videos in low-temperature scenes can consume more power.
- ✧ EIS 4K30 is in anti shake mode, and 4K30 (9:16) is in vertical shooting mode.
- ✧ FAT32 format Micro SD card stops recording when the storage of each file is over 4GB and starts to record again on a new file.

### ● Pre-record: Off / On

Default setting is **Off**.

After enabling prerecord, the camera can start recording videos from a few seconds before pressing the shutter button. The prerecord function is very suitable for recording exciting moments of unexpected activities, such as fishing, etc

Notes:

- ✧ The length of pre recording time depends on the resolution of the video.
- ✧ If time-lapse recording or slow motion is on, pre record will not be available. You must first turn off time-lapse recording or slow motion before enabling pre recording.



- **Looping Video : Off / 1Min / 3Min / 5Min**

Default setting is **Off**.

The files will be saved every 3 minutes if you choose 3 minutes. When the memory card is full, the new files will cover the existed one if the loop recording is on; If it is off, the camera won't record any more when the card is full, need to format the memory card or change a new one.

Note: if time-lapse recording or slow motion is on, loop recording will not be available. You must first turn off time-lapse recording or slow motion before turning it on.

- **Slow Motion : Off / On**

Default setting is **Off**.

Slow Motion Video, also known as high-frame-rate video, refers to a technique where the camera records video at a higher frame rate and then plays it back at a lower speed, typically 30 frames per second, resulting in a smoother and more dramatic effect.

Note: If Slow Motion is on, EIS, Time-Lapse and Looping Video will not be available.

- **Time Lapse: Off / 1 Sec / 3 Sec / 5 Sec / 10 Sec / 30 Sec / 1 Min**

Default setting is **Off**.

Time Lapse creates video from frames captured at specific intervals. This option lets you capture a time lapse event and immediately view or share it as a video. Select 3 seconds means recording 3 seconds to get one frame per second. For example: If you select 4K/30FPS and 3 secs, you need to record 90secs, then you can get 1 sec video for 4K/30FPS.

Notes:

✧ Time Lapse Video is captured without audio.

✧ If you select Time-Lapse, EIS, Looping Video and Slow Motion will not be available.

- **Date Stamp: Off / Date / Date & Time**

Default setting is **Date & Time**.

If you turn on Stamp, this camera adds stamp to the video you take.

If you turn off Stamp, this camera will not add stamp to the video you take.

Note: This camera does not add date stamp to the videos you take if time lapse is on.

- **Exposure(EV): -2 ~ +2**

Default setting is **0**.

By default, your camera uses the entire image to determine the appropriate exposure level. However, EV lets you select an area that you want the camera to prioritize when

determining exposure. This setting is particularly useful in shots where an important region might otherwise be over- or underexposed.

Notes:

- ✧ It is recommended to adjust the EV value higher in the low light scenes such as indoor/night/tunnel/underground parking lot to obtain better low light video effect.
- ✧ To avoid overexposure, it is recommended to lower the EV value in high light areas such as beaches and snow to achieve better video effects.

## ■ Photo Setting Mode

- 1) Verified in Photo Mode, tap the "Settings" icon in the bottom right corner of the screen to enter Photo Setting menu.
- 2) Slide up / down quickly in the gray area on the screen to cycle through various options, tag the target option or press the "Shutter Button" to select the desired option to set.
- 3) Tap the "Return" icon in the bottom left corner of the screen or press the "Power Button" to exit.

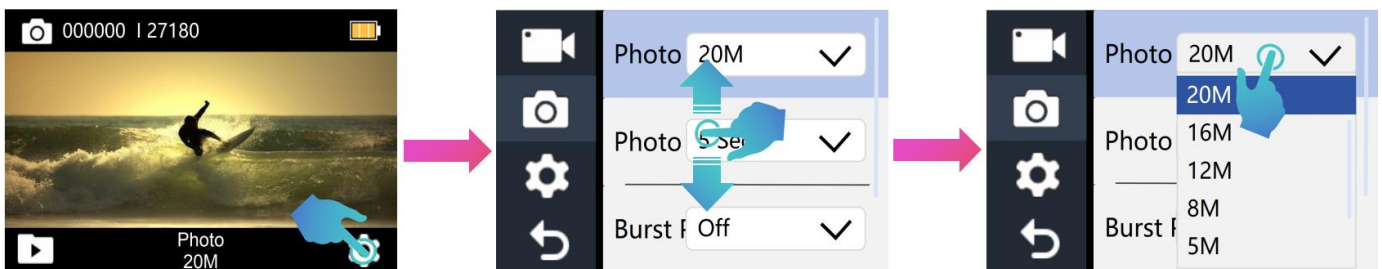

### ❖ **Photo Settings:**

- **Photo Resolution:** 48M / 36M / 20M / 16M

Default setting is **20MP**.

- **Photo Lapse:** Off / 2 Sec / 5 Sec / 10Sec / 20Sec / 30Sec / 1Min

Default setting is **Off**.

Photo Time Lapse captures a series of photos at specified intervals. Use this mode to capture photos of any activity, then choose the best ones later.

Note: If Photo Lapse is on, Burst Photo and self-timer will not be available.

- **Burst Photo:** Off / 3 Photos / 5 Photos

Default setting is **Off**.

Continuous shooting can take up to 5 photos in a certain amount of time, making it ideal for fast-moving events.

Note: If Burst Photo is on, Photo Lapse and self-timer will not be available.

- **Self-timer:** Off / 2 Sec / 5 Sec / 10 Sec

Default setting is **Off**.

A self- timer gives a delay between pressing the shutter release and the shutter's firing. It is most commonly used to let photographers to take a photo of themselves.

Note:If self-imer is on, Time Lapse Photo Lapse and Burst Photo will not be available.

## ■ System Setting Mode

- 1) Verified in Video / Photo Mode, tap the "Settings" icon in the bottom right corner of the screen to enter Video /Photo Setting menu.
- 2) Tap the "Settings" icon on the left side of the screen to enter the system settings menu. or press the "Power Button" to switch to the system settings menu.
- 3) Slide up / down quickly in the gray area on the screen to cycle through various options, tag the target option or press the "Shutter Button" to select the desired option to set.
- 4) Tap the "Return" icon in the bottom left corner of the screen or press the "Power Button" to exit.

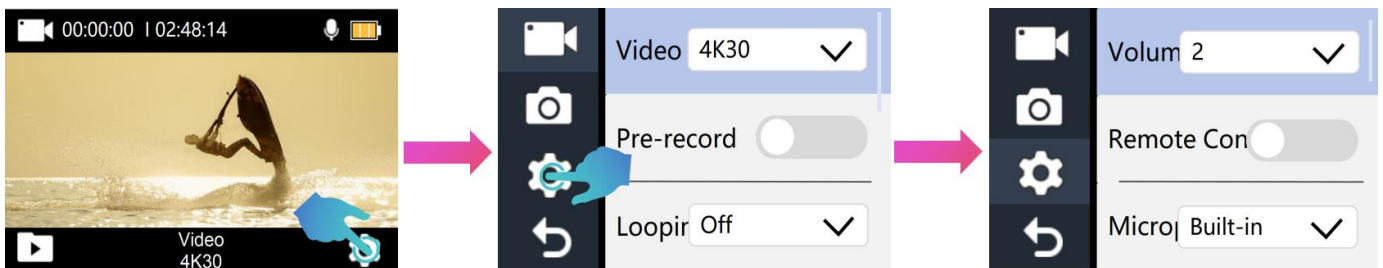

### ❖ **System Settings:**

#### ● **Volume: Off / 1 / 2 / 3**

Default setting is **2**.

Set the volume of sound recorded by the camera.

#### ● **Remote Control: Off / On**

Default setting is **Off**.

If Remote Control is on, The camera can be controlled through a exclusive remote controller.

#### ● **Power Frequency: 50HZ / 60HZ**

Default setting is **50HZ**.

#### ● **Car Mode: Off / On**

Default setting is **Off**.

If you turn on car mode and connect camera with car charger, the camera will turn on automatically and start recording if you start your car' s engine. and the camera will turn off and stop recording if you Turn off the car' s engine.

Notes:

- ✧ Must use 5V 1-2A output car charger.
- ✧ Using as a dash cam, we suggest to turn on the Loop Video, Car Mode, Upside Down and Screen Saver at same time.

- **ISO: Auto / ISO100 / ISO200 / ISO400 / ISO800 / ISO1600 / ISO3200**

Default setting is **Auto**.

ISO determines the camera's sensitivity to light, and creates a trade-off between brightness and resulting image noise. Image noise refers to the degree of graininess in the image. In low light, higher ISO values result in brighter images, but with greater image noise. Lower values result in lower image noise, but darker images. When you change this setting, the display immediately shows you the effect on your image.

- **White Balance: Auto / Cloudy / Daylight / Incandesc. / Fluoresc.**

Default setting is **Auto**.

AWB (Auto White Balance) lets you adjust the color temperature of videos and photos to optimize for cool or warm lighting conditions. When you change this setting, the LCD display immediately shows you the effect on your image.

- **Language: English/简体中文/繁體中文/ Italiano / Español / Portugues / Deutsch / Français / 日本語 / 한국어**

Default setting is **English**.

You can set the camera's system language.

- **Date Format: YY MM DD/ MM DD YY / DD MM YY**

The date and time are automatically updated when you connect your camera to the Wi-Fi app. However, you can manually change these settings, if needed.

Note: If the battery is removed from the camera for an extended period of time, the date and time will be reset automatically.

- **Date & Time: Year-Month-Day-Hour-Minute-Second / Cancel / Confirm**

- **Screen Saver: Off / 1Min / 3Min / 5Min**

Default setting is **Off**.

Turns off the screen after a period of inactivity to save battery life. To turn on the screen again, press any button on the camera.

- **Power Off: Off / 1Min / 3Min / 5Min**

Default setting is **Off**.

Powers off your camera after a period of inactivity to save battery life.

- **Upside Down: Off / On**

Default setting is **Off**.

This setting determines the orientation of setting menu.

- **Format: Cancel / Confirm**

To keep your micro SD card in good condition, reformat it on a regular basis. Reformatting erases all of your content, so be sure to offload your content first.

- **Reset: Cancel / Confirm**

This option resets all settings to their default values.

- **Version : Brand / Model / Version / Updated**

You can check the model, software version and updated time of your camera.

Note: Software version is the main information of firmware upgrade, troubleshooting and after-sales.

## ZOOM IN/OUT

The camera supports 5x zoom function and is set to not zoom by default. The zoom function is available in all shooting modes.

Please follow the instructions and illustrations below to use the zoom function.

- (1) Turn on the camera.
- (2) Enter any shooting mode.
- (3) Tap on the zoom area, and the touch bar will be displayed.
- (4) Swipe up or down in the touch bar area to adjust the focus.

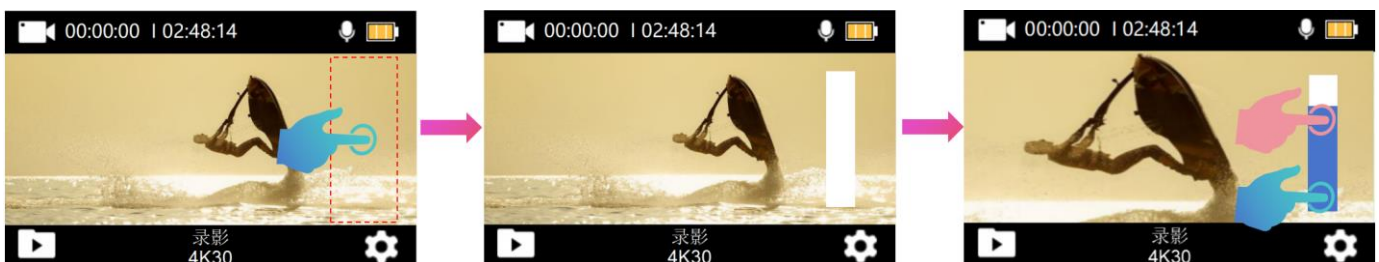

After no action is taken, the touch bar will automatically hide and exit.

## CONNECTING TO WIFI APP

The Wi-Fi App lets you control your camera remotely using a smart phone or tablet. Features include full camera control, live preview, playback and sharing of selected content and more.

## ■ Download and Install FUN DV app

- **Option 1:** Download the **FUN DV** App or to your phone from the Google Play or Apple App Store.



- **Option 2:** Scan the QR code below to download the **FUN DV** App or to your phone.



**Android 7.0**  
or later



**iOS 10.0**  
or later



Notes:

Google, Android, Google play, App Store and other marks are the trademarks of Google LLC.

## ■ Turn On / Off Camera Wi-Fi

Turn on the camera, and verified it is in Video mode, slide down quickly on the screen or Press the Up Button shortly to turn on the camera's WIFI

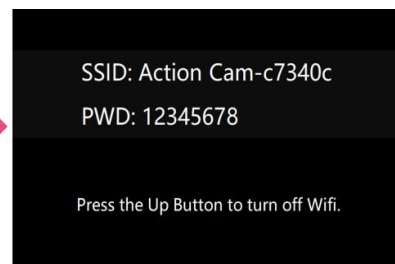
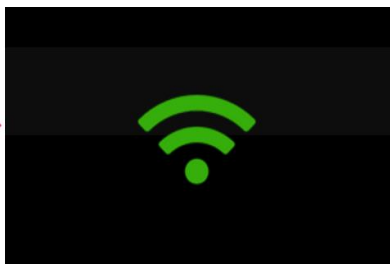
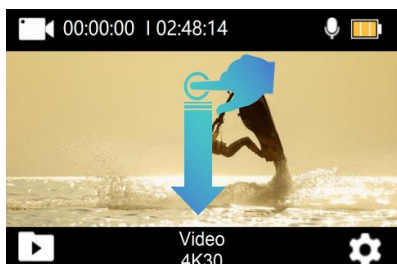

## ■ Connect to the FUN DV APP

- 1) Turn on Carmera' s Wi-Fi;
- 2) Turn on Wi-Fi Setting of your phone, connect to the Wi-Fi SSID named "**Action Cam \_xxxx** (Random serial number)" ;
- 3) Enter the password: "**12345678**" ;
- 4) Launch the app "**FUN DV**" on your phone



Notes:

- The camera Wi-Fi is a point to point signal source, which supports only one telephone connection at one time and does not support two or more phones. If two phones turn on Wi-Fi at the same time, one phone is successfully connected to the camera's Wi-Fi, and the other will no longer connect to the camera, or even interfere with the transmission of the signal.
- The camera Wi-Fi bandwidth is relatively narrow, and its signal will be affected by distance, other signals, electromagnetic waves, obstacles and other factors. 0.5 to 3 seconds signal delay is normal. Wi-Fi distance is about 5~10 meters.
- When the phone and camera connect through Wi-Fi, the power of the camera will increase. The camera's temperature will rise rapidly, and the consumption of camera batteries will also increase. This is a normal phenomenon.
- If you find your phone can not connect the camera's WIFI, please confirm that your connection is correct, if yes, and still can not connect. Please delete the WI-FI SSID of the camera in your phone Wi-Fi setting and reconnect. If necessary, you can also delete the Wi-Fi APP/APK from your phone and re-download and re-install it.

## PLAYBACK YOUR CONTENT

You can play back your content on the camera screen. You can also play back content by inserting the micro SD card directly into a computer or TV. With this method, playback resolution depends on the resolution of the device and its ability to play back that resolution.

2 Playback Mode: Video Playback Mode & Photo Playback Mode.

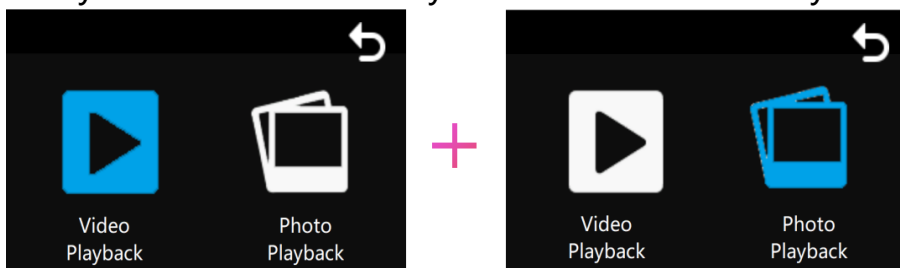

In Playback Mode, You can playback or delete your content on the camera.

### ■ Playback videos and photos on your camera

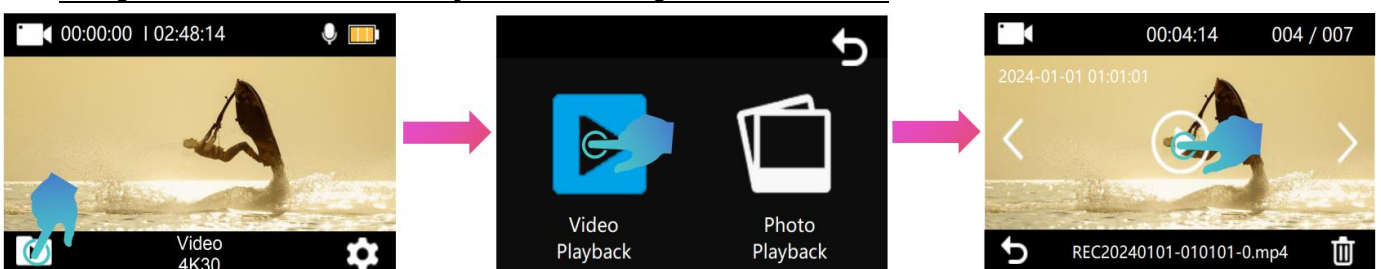

1. Turn on camera.
2. Tap "Playback" icon at the left corner of the screen to enter playback mode.
3. Tap "Video Playback" / "Photo Playback" icon to enter.

4. Tap "Forward" or "Backward" icon to locate video files / playback photo files.
  5. Tap "playback" / "Pause" icon or press Shutter Button to start/pause playing video file.
  6. To exit, tap return icon or press Power Button.
- Note: If your memory card contains a lot of content, it might take a minute for it to load.

### ■ Delete single file on camera

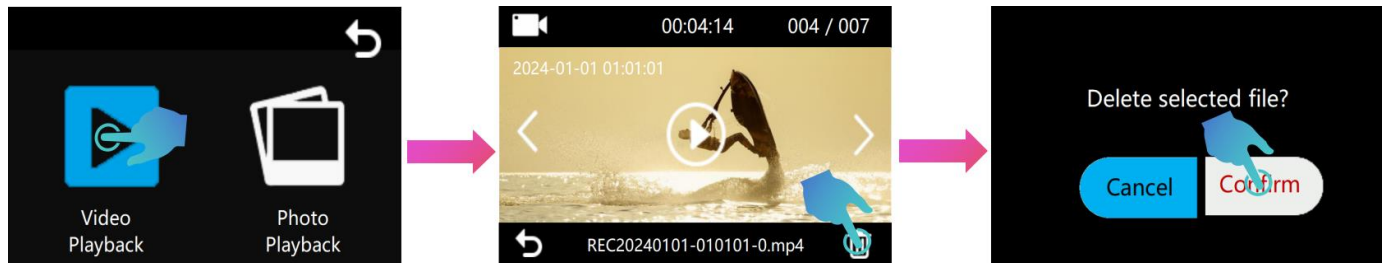

1. Enter Video / Photo Playback mode.
2. Tap "Forward" or "Backward" icon to locate the video or photo file you want to delete.
3. Tap the "Delete" icon in the bottom right corner of the screen.
4. Tap the "Confirm" icon to delete the selected file.

## REMOTE CONTROLLER

Place the Remote Control On Your Wrist and Acquiesce Ultra-convenient Control For Hiking,Biking, Skiing,Bungee and more while installing the camera on your Helmet or other place.

### ■ Remote: Splash-proof only / Range: 5M

### ■ How to turn on/off the remote function

Select **ON/OFF** in the System Setting Menu to turn on/off the remote controller.



Note: Verify the camera is in Video/Photo preview mode first, if the camera is set in Playback or Setting Menu, the camera can not receive the remote signal and can not be controlled by the remote.

## ■ VIDEO

### ● **To start recording**

Press the Grey Video Button.

### ● **To stop recording**

Press the Grey Video Button again.

## ■ **PHOTO**

### ● **To take a photo**

Press the Red Photo Button. The camera will emit a camera shutter sound.

Notes

- Verify the camera is in Video/Photo preview mode, if the camera is in Playback or Setting Menu, the camera can not be controlled by the remote.
- If not used for a long time, be sure to remove the remote control battery and place it in a safe and reliable place.
- The remote control will always be in standby mode. If the indicator light is not on, it indicates that the battery is low, please regularly and promptly replace the remote control battery.

## **BATTERY**

The camera contains sensitive components, including the battery. Avoid exposing your camera to very cold or very hot temperatures. Low or high temperature conditions may temporarily shorten the battery life or cause the camera to temporarily stop working properly. Avoid dramatic changes in temperature or humidity when using the camera, as condensation may form on or within the camera.

### ■ **Battery Storage and Handling**

- Do not store in temperature above 140°F/60°C.
- Avoid exposing your camera to very cold or very hot temperatures. Low or high temperature conditions may temporarily shorten the battery life or cause the camera to temporarily stop working properly. Avoid dramatic changes in temperature or humidity when using the camera, as condensation may form on or within the camera.
- Do not dry the camera or battery with an external heat source such as a microwave oven or hair dryer.
- Damage to the camera or battery caused by contact with liquid inside the camera is not covered under the warranty.
- Do not store your battery with metal objects, such as coins, keys or necklaces. If the battery terminals come in contact with metal objects, this may cause a fire.
- Do not make any unauthorized alterations to the camera. Doing so may compromise safety, regulatory compliance, performance, and may void the warranty.
- Please do not throw the camera or its battery to the garbage, find a specific recycling point for it.

### **WARNING:**

- Do not drop, disassemble, open, crush, bend, deform, puncture, shred, microwave,

incinerate or paint the camera or battery.

- Do not insert foreign objects into the battery opening on the camera.
- Do not use the camera or the battery if it has been damaged - for example, if cracked, punctured or harmed by water. Disassembling or puncturing the battery can cause an explosion or fire.

## ■ **Charging the Battery**

- 1.Connect the camera to USB power supply (5V/1A commended).
- 2.The charging status light remains ON while the battery is charging.
- 3.The charging status light will turn OFF when the battery is fully charged.

Notes:

- ✧ Charging time: 4-hours for 5V 1A power supply
- ✧ Please make sure the camera is shuttled down while charging.
- ✧ Remove the battery before using as a dash camera and use 5V/1A car charger.

## ■ **Maximizing Battery Life**

If the battery reaches 0% while recording, the camera saves the file and powers off.

To maximize battery life, follow these guidelines when possible:

- Turn off Wireless Connections
- Capture video at lower frame rates and resolutions
- Use Screen Saver setting.

*Specification could be subject to modification due to updating without notice, please regard the actual product as the standard form. If need the newest updated software, please contact our after sale service team!*

## **CONTACT US**

**Specifications are subject to change without prior notice. Please refer to the actual specifications!**

For any inquiries, issues or comments concerning our products, please

send E-mail to the

address below or call us. We will respond as soon as possible.

**E-mail:** [cs@onlincam.com](mailto:cs@onlincam.com)

**Web:** <https://www.onlincam.com>